



HILLINGDON
LONDON



Petition Hearing - Cabinet Member for Planning, Transportation and Recycling

Date: WEDNESDAY, 14
DECEMBER 2011

Time: 7.00 PM

Venue: COMMITTEE ROOM 3 -
CIVIC CENTRE, HIGH
STREET, UXBRIDGE UB8
1UW

**Meeting
Details:** Members of the Public and
Press are welcome to attend
this meeting

This agenda and associated reports can be made available in other languages, in braille, large print or on audio tape on request. Please contact us for further information.

Cabinet Member hearing the petitions:

Keith Burrows, Cabinet Member for Planning, Transportation and Recycling

How the hearing works:

The petition organiser (or his/her nominee) can address the Cabinet Member for a short time and in turn the Cabinet Member may also ask questions.

Local ward councillors are invited to these hearings and may also be in attendance to support or listen to your views.

After hearing all the views expressed, the Cabinet Member will make a formal decision. This decision will be published and sent to the petition organisers shortly after the meeting confirming the action to be taken by the Council.

Published: Tuesday, 6 December 2011

Contact: Charles Francis
Tel: 01895 556454
Fax: 01895 277373
Email: cfrancis@hillington.gov.uk

This Agenda is available online at:

<http://modgov.hillingdon.gov.uk/ieListDocuments.aspx?CId=252&MId=1023&Ver=4>

Lloyd White
Head of Democratic Services
London Borough of Hillingdon,
3E/05, Civic Centre, High Street, Uxbridge, UB8 1UW
www.hillingdon.gov.uk



INVESTOR IN PEOPLE

Useful information

Bus routes 427, U1, U3, U4 and U7 all stop at the Civic Centre. Uxbridge underground station, with the Piccadilly and Metropolitan lines, is a short walk away. Limited parking is available at the Civic Centre. For details on availability and how to book a parking space, please contact Democratic Services

Please enter from the Council's main reception where you will be directed to the Committee Room. An Induction Loop System is available for use in the various meeting rooms. Please contact us for further information.

Please switch off any mobile telephones and BlackBerries™ before the meeting. Any recording of the meeting is not allowed, either using electronic, mobile or visual devices.

If there is a FIRE in the building the alarm will sound continuously. If there is a BOMB ALERT the alarm sounds intermittently. Please make your way to the nearest FIRE EXIT.



Agenda

CHAIRMAN'S ANNOUNCEMENTS

PART 1 - MEMBERS, PUBLIC AND PRESS MAY ATTEND

1 To confirm that the business of the meeting will take place in public.

2 To consider the report of the officers on the following petitions received.

Please note that individual petitions may overrun their time slots. Although individual petitions may start later than advertised, they will not start any earlier than the advertised time.

	Start Time	Title of Report	Ward	Page
3	7pm	Montague Road, Uxbridge - Petition Requesting Further Speed And Traffic Surveys	Uxbridge North	1 - 6
4	7pm	Knoll Crescent, Northwood - Petition Requesting Permission To Park On The Footway	Northwood	7 - 12
5	7.30pm	Little Road, Hayes - Petition Objecting To The Proposed Parking Management Scheme	Townfield	13 - 20
6	8pm	Coldharbour Lane - Petition Requesting A Residents Parking Scheme	Townfield	21 - 28
7	8pm	New Broadway And Uxbridge Road, Hayes - Petition Requesting 'Stop & Shop' Scheme	Hillingdon East	29 - 34

This page is intentionally left blank

MONTAGUE ROAD, UXBRIDGE – PETITION REQUESTING FURTHER SPEED AND TRAFFIC SURVEYS.

Cabinet Member	Councillor Keith Burrows
Cabinet Portfolio	Cabinet Member for Planning, Transportation and Recycling
Officer Contact	Steven Austin Planning, Environment, Education and Community Services
Papers with report	Appendix A

HEADLINE INFORMATION

Purpose of report	To inform the Cabinet Member that a petition has been received from residents living in Montague Road Uxbridge asking for another 24/7 speed and traffic survey.
Contribution to our plans and strategies	The request can be considered as part of the Council's strategy for road safety.
Financial Cost	The cost to arrange a speed and traffic classification survey in two locations in Montague Road is £370.
Relevant Policy Overview Committee	Residents' and Environmental Services
Ward(s) affected	Uxbridge North

RECOMMENDATION

That the Cabinet Member:

1. Meets and discusses with petitioners their concerns regarding rat-running and speeding on Montague Road.
2. Subject to 1 above decides if officers should commission further independent 24/7 speed and traffic surveys at locations agreed with the petitioners and report back to the Cabinet Member.

INFORMATION

Reasons for recommendation

To investigate in further detail concerns of the petitioners.

Alternative options considered

None as petitioners have made a specific request.

Comments of Policy Overview Committee(s)

None at this stage

Supporting Information

1. A petition of 20 valid signatures has been received from residents of Montague Road, Uxbridge under the following heading

“This is a new petition to the London Borough of Hillingdon regarding the rat run and speeding in Montague Road as the Council did not agree with us on the last petition”

2. Montague Road is a narrow mainly residential road close to Uxbridge Town Centre. The location is indicated on the plan attached as Appendix A to this report.

3. The Cabinet Member will remember hearing a petition in March 2009 from residents of Montague Road, Iffley Close, Grove Road and Grove Way requesting a change to the residents' parking scheme such that it would operate at all times. In a letter attached to that petition, the organiser raised concerns about traffic using Montague Road and Grove Road as a 'rat run' *“to and from The Chimes car park at great speed to beat the traffic lights”*

4. Following the meeting with petitioners the request to extend the times of operation of the permit scheme was added to the parking scheme programme. Following extensive consultation with residents, which have shown a positive level of support, the changes to the operational times will be implemented this winter. The additional request to investigate options to deal with 'rat running' and traffic speeds was considered separately under the Council's road safety programme.

5. Over a week long period between 10th and 16th June 2010 a 24 hour independent speed and traffic classification survey was undertaken at one location on Montague Road between its junctions with Grove Road and Iffley Close. The data was captured using "road tubes" which accurately measure vehicle speeds and types.

6. The data from this survey indicated that the 85th percentile was 20.1 mph eastbound and 18.8 mph westbound. This is the speed at which 85% of vehicles travel at or below which is the standards used by the police service, motoring organisations and road safety practitioners. These moderate traffic speeds were not considered sufficient grounds to consider any additional traffic calming measures in the area.

7. However, in a covering letter and attached plan submitted with the present petition the lead petitioner suggests that the residents are unhappy with the speed data captured and stated the following;

“We enclose a new petition regarding the rat run and speeding in Montague Road, as the residents are NOT convinced with your report.

The red line marked on the enclosed map of Montague Road, is where the Council put the traffic and speed check wires. This is where traffic HAS to slow down, due to a junction (Grove Road), and also a chicane, which is caused because the residents parking changes here from one side of the road to the other. When drivers pass this chicane, they then speed off again. We, the residents, would like a speed check put in where marked on the map, not where it was before”.

8. It would appear from the petition that residents are still concerned with vehicle speeds in Montague Road and have suggested two alternative locations where they believe the surveys would support their concerns. Therefore, subject to discussions with residents, the Cabinet Member may decide to instruct officers to commission a further independent speed and vehicle count survey at two locations on Montague Road. It is recommended that petitioners be invited to confirm the precise locations they wish these surveys to take place are as indicated on the attached plan as Appendix A.

Financial Implications

The cost of a speed and traffic survey for two locations in Montague Road is £370 which subject to the usual approvals could be funded from the Road Safety Programme budget. This would require the approval of release of funding from capital moratorium.

EFFECT ON RESIDENTS, SERVICE USERS & COMMUNITIES

What will be the effect of the recommendation?

To allow the Cabinet Member to discuss in detail with petitioners their concerns with traffic speeds in Montague Road.

Consultation Carried Out or Required

None at this stage.

CORPORATE IMPLICATIONS

Corporate Property and Construction

The Head of Corporate Property and Construction is in support of the recommendations in this report.

Legal

There are no special legal implications for the recommendations outlined above.

Should there be a decision that further measures are to be considered following the 24/7 speed and traffic surveys, then the relevant statutory provisions will have to be identified and considered.

In considering the consultation responses, decision makers must ensure there is a full consideration of all representations arising including those which do not accord with the officer recommendation. The decision maker must be satisfied that responses from the public are conscientiously taken into account.

BACKGROUND PAPERS

Petition received – 7th June 2011

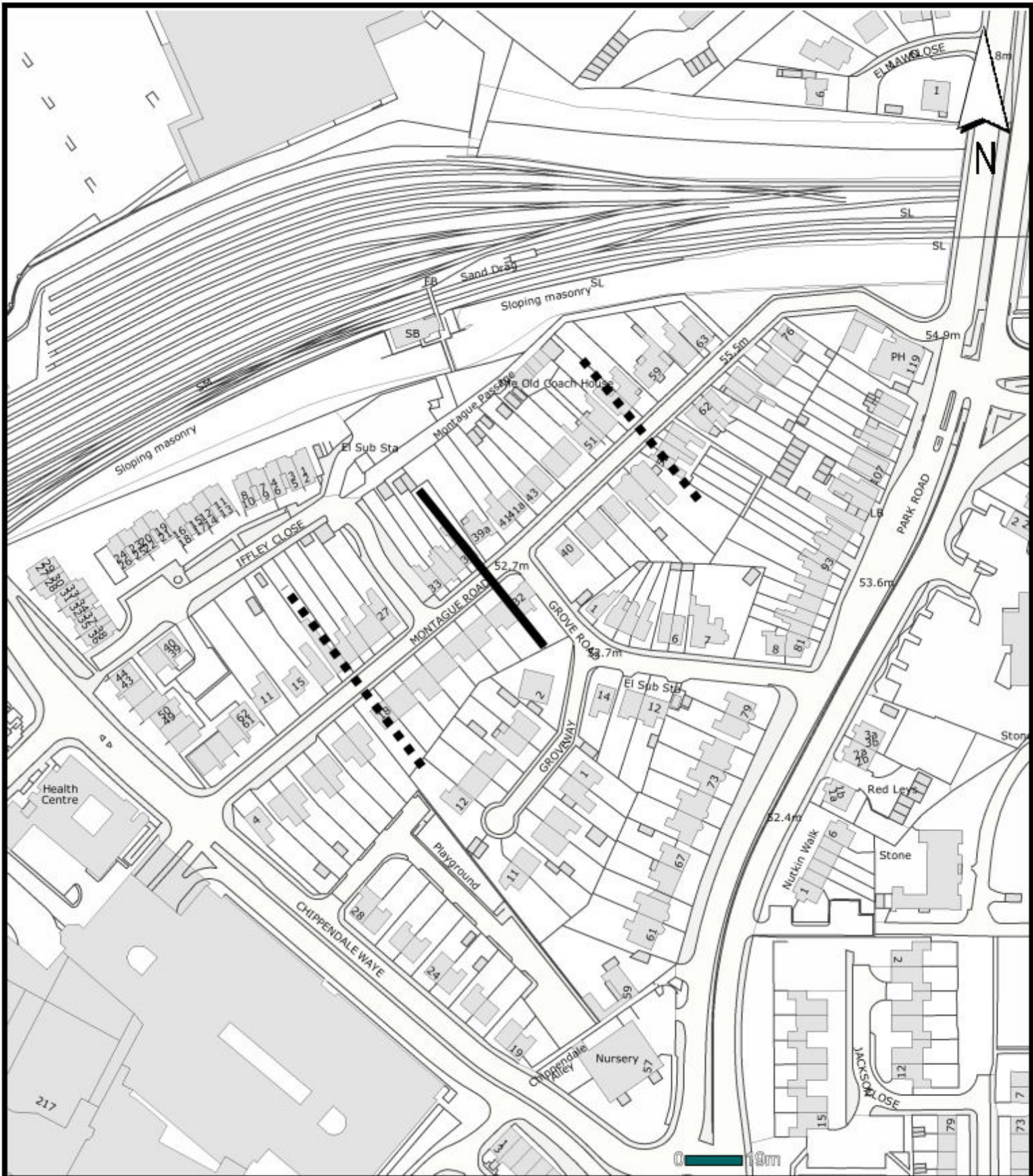

Montague Road, Uxbridge Speed survey locations

Appendix A

Date November 2011

Scale 1:1,750



Location of speed survey undertaken
10th - 16th June 2010

Residents' suggested locations for
additional speed surveys

This page is intentionally left blank

KNOLL CRESCENT, NORTHWOOD – PETITION REQUESTING PERMISSION TO PARK ON THE FOOTWAY

Cabinet Member	Councillor Keith Burrows
Cabinet Portfolio	Planning, Transportation and Recycling
Officer Contact	Catherine Freeman Planning, Environment, Education and Community Services
Papers with report	Appendix A

HEADLINE INFORMATION

Purpose of report	To inform the Cabinet Member that a petition of 21 signatures has been received from residents requesting footway parking to be permitted on the southern section of Knoll Crescent
Contribution to our plans and strategies	The request can be considered as part of the Council's strategy for on-street parking
Financial Cost	There are no financial implications to this report
Relevant Policy Overview Committee	Residents' & Environmental Services
Ward(s) affected	Northwood Ward

RECOMMENDATION

That the Cabinet Member:

1. Meets with the petitioners and considers their request for a footway parking scheme in Knoll Crescent
2. Subject to (1) asks officers to add this request to the Council's Footway Parking Programme for subsequent investigation and the development of possible options when resources permit

INFORMATION

Reasons for recommendation

The petition hearing will provide a valuable opportunity to hear directly from the petitioners of their concerns and suggestions.

Alternative options considered / risk management

These can be discussed in greater detail with petitioners

Comments of Policy Overview Committee(s)

None at this stage

Supporting Information

1. A petition with 21 signatures has been submitted to the Council under the following heading *“We, the undersigned residents of Knoll Crescent 68 – 137, Northwood, wish to petition to give legal authority for the parking of motor vehicles with wheels on the pavement of Knoll Crescent. With the increased number of vehicles, this is essential for access by emergency vehicles and delivery lorries and vans”*
2. Knoll Crescent is a residential road in Northwood which is divided into two sections and is indicated in Appendix A. The southern end of Knoll Crescent is isolated from the rest of Knoll Crescent by the rear gardens of properties in The Drive. The petition is from residents solely from the southern section of Knoll Crescent and represents 95% of households.
3. As the Cabinet Member will be aware, the Council previously received a petition from residents living in the northern section of Knoll Crescent requesting permission to park with two wheels on the footway on one side of the road. In August 2011, following a feasibility study, the Council carried out an informal consultation with residents, seeking their views on a proposed footway parking scheme outside Nos. 35 – 83. Although analysis of the consultation results indicated balanced views for and against the proposed footway parking scheme, the majority of directly affected residents were opposed to the proposal. As a result, the Council has not progressed these proposals and is keeping this section of Knoll Crescent under review.
4. It is suggested that the Cabinet Member meets with the petitioners to discuss in greater detail their concerns with parking issues in their section of Knoll Crescent. However, it would appear from initial investigations that this section of Knoll Crescent conforms to the Council’s criteria for footway parking which may provide sufficient flexibility for residents and retain access for emergency and delivery vehicles. It is therefore recommended that the request is added to the footway parking scheme programme for detailed site inspection.

Financial Implications

There are none associated with the recommendations to this report. The investigation of feasible measures can be carried out with in-house resources. However, if measures are introduced in Knoll Crescent, a budget will need to be identified but the cost will not be known until the final details have been agreed.

EFFECT ON RESIDENTS, SERVICE USERS & COMMUNITIES

What will be the effect of the recommendation?

It will allow further consideration of the petitioners' concerns.

Consultation Carried Out or Required

Consultation with local residents would be carried out if suitable measures could be identified to address the petitioners' concerns.

CORPORATE IMPLICATIONS

Legal

There are no special legal implications for the recommendations outlined above.

Should there be a decision, following further investigation as per recommendation 2, that a footway parking scheme is to be considered, then the relevant statutory provisions will have to be identified and considered.

In considering the consultation responses, decision makers must ensure there is a full consideration of all representations arising including those which do not accord with the officer recommendation. The decision maker must be satisfied that responses from the public are conscientiously taken into account.

Corporate Property & Construction

The Head of Corporate Property & Construction is in support of the recommendations in this report.

Relevant Service Groups

None at this stage

BACKGROUND PAPERS

Petition requesting a footway parking scheme on a section of Knoll Crescent, Northwood, received 15th June 2011.

This page is intentionally left blank

This map is based upon Ordnance Survey material with the permission of Ordnance Survey on behalf of the Controller of Her Majesty's Stationery Office. All rights reserved. Unauthorised reproduction infringes Crown copyright and may lead to prosecution or civil proceedings. London Borough of Hillingdon 100019283 2011

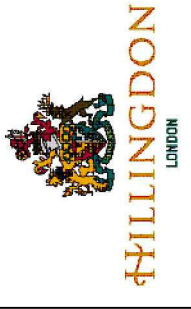

Project	Knoll Crescent, Northwood		
Description	Location plan		
Scale	Drawn (Initials/Date)	Checked (Initials/Date)	
NTS	CF 11/2011		
Project No.	Drawing No.	Rev.	

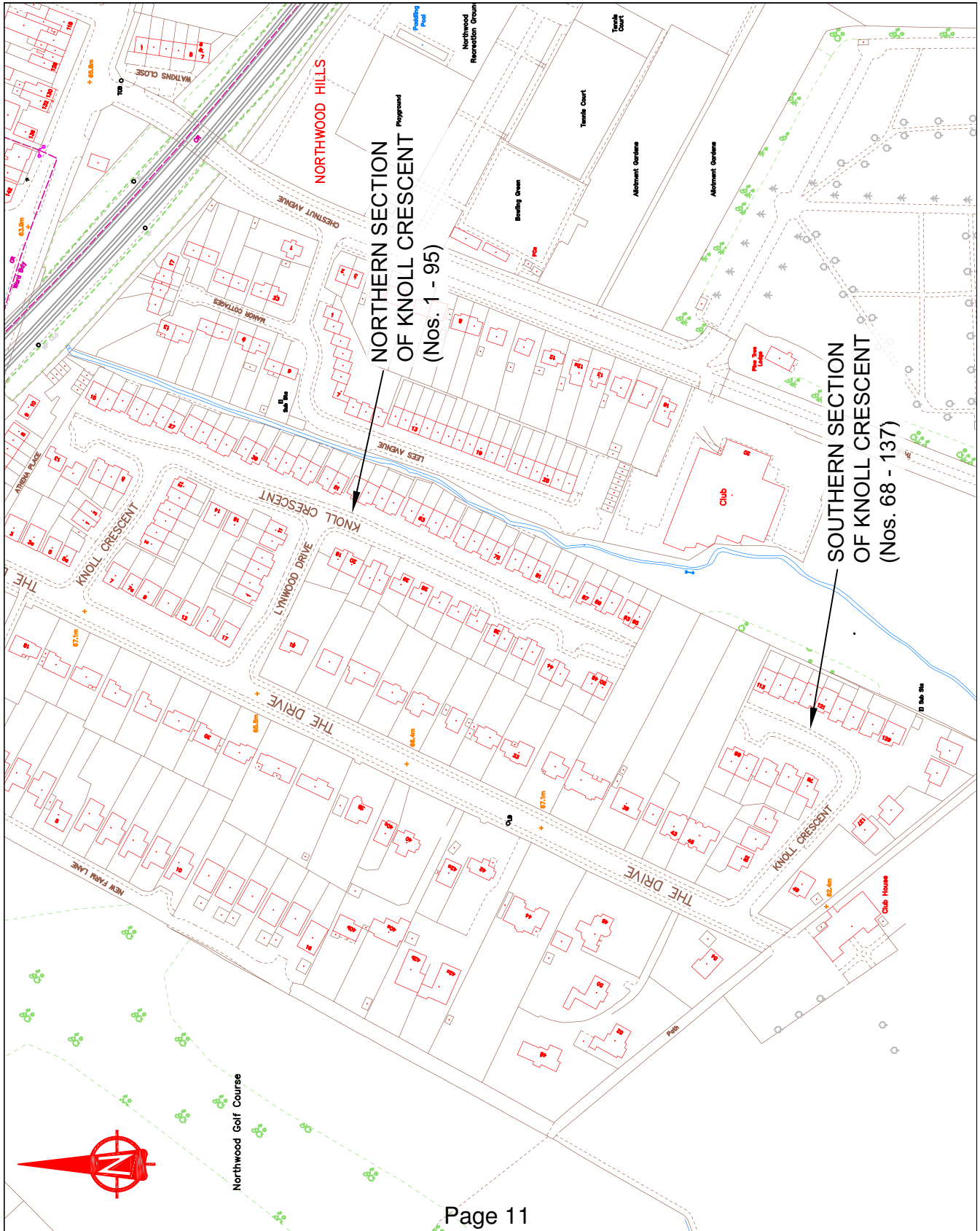

This page is intentionally left blank

LITTLE ROAD, HAYES – PETITION OBJECTING TO THE PROPOSED PARKING MANAGEMENT SCHEME

Cabinet Member	Councillor Keith Burrows
Cabinet Portfolio	Planning, Transportation & Recycling
Officer Contact	Hayley Thomas – Planning, Environment, Education and Community Services
Papers with report	Appendices A & B

HEADLINE INFORMATION

Purpose of report	To inform the Cabinet Member that residents of Little Road have organised a petition objecting to the proposed Parking Management Scheme within their road.
Contribution to our plans and strategies	The request can be considered in relation to the Council's strategy for on-street parking controls.
Financial Cost	There are none associated to the recommendation of this report.
Relevant Policy Overview Committee	Residents and Environmental Services.
Ward(s) affected	Townfield

RECOMMENDATION

That the Cabinet Member;

1. Discusses with petitioners and listens to their concerns regarding the proposed parking scheme in their road.
2. Asks officers to include the petition request and the outcome of discussions with petitioners in the forthcoming report incorporating all representations received from statutory consultation on the proposed Parking Management Scheme in Austin Road, Little Road and Silverdale Road.

INFORMATION

Reasons for recommendation

Following statutory consultation on parking proposals, all comments received must be considered by the Council before a final decision is made. A report will subsequently be drafted detailing these comments which can include this petition together with the outcome of discussions with the Cabinet Member at the petition evening.

Alternative options considered / risk management

These will be discussed with petitioners.

Comments of Policy Overview Committee(s)

None at this stage.

Supporting Information

1. A petition with 28 signatures has been received from residents of Little Road objecting to the proposed extension to the Hayes "HY1" Parking Management Scheme in its present form.
2. The Cabinet Member will recall hearing a petition from residents of Little Road requesting a residents' parking scheme which would only be available to residents of Little Road. At the time it was pointed out that one road in isolation would not be considered for a Parking Management Scheme as it is likely the problem would transfer into neighbouring roads. Consequently, it was decided that neighbouring roads which may also suffer with all day non-residential parking, would be included in a subsequent consultation.
3. Following the previous petition from residents of Little Road and residents of Blyth Road/Clayton Road, the Council proposed an extension to "Zone HY1" of the Hayes Parking Management Scheme in Austin Road, Blyth Road, Clarendon Road, Clayton Road, Little Road and Silverdale Road, as indicated on plan attached as Appendix A. Statutory consultation was conducted over a three week period from 25th May to 15th June 2011 where residents were given the opportunity to inspect plans of the proposed scheme and asked for their comments. During this period the Council received a number of responses, including the petition being presently considered from residents of Little Road specifically objecting to the proposed scheme being extended to Austin Road and Silverdale Road as well as Little Road.
4. In order for the rest of the scheme in Blyth Road, Clarendon Road and Clayton Road not to be delayed, the responses to the consultation from these roads have been included in a separate report to the Cabinet Member which will be considered in due course. Therefore, it is recommended that the proposals for Austin Road, Little Road and Silverdale Road be deferred until residents of Little Road have had the opportunity to discuss in detail their concerns with the Cabinet Member.
5. In a covering letter to the petition the organiser raised a number of concerns residents have with the proposed scheme. The first concern suggests that residents of Austin Road and Silverdale Road will park their vehicles in Little Road due to the lack of on-street parking available in these other two roads. The petitioners suggest that at present residents of Little Road have great difficulty finding safe and convenient parking and that to include residents of Austin Road and Silverdale Road will, they feel, exacerbate the parking problem. They also raised concerns with the continuous bay layout proposed; their fear was that residents from

neighbouring roads would park across dropped kerbs obstructing access for Little Road residents to their off-street parking.

6. The letter also indicates that residents would prefer Little Road to have its own independent scheme with longer hours of operation. This suggestion was raised during the previous petition hearing for a residents' parking scheme in Little Road and the Cabinet Member will recall that he explained – with the support of a local Ward Councillor - that one road in isolation would not be considered for a residents' parking scheme and that consequently surrounding roads, which also experienced parking problems, would be included in the consultation.

7. The latest petition also highlights concerns with the proposed layout of the parking bays in Austin Road. The existing restrictions include “at any time” restrictions in the turning head and on the southeast side of Austin Road which runs adjacent to the rear of the even numbered properties in Little Road. The proposed scheme in Austin Road included relocating the existing “at any time” restrictions to the northwest side of Austin Road and introduce residents' parking places on the southeast side, as shown in the plan attached as Appendix B, to optimise the number of parking places in Austin Road. Petitioners believe that having the parking places which run adjacent to the rear of the even numbered properties in Little Road could encourage anti-social behaviour and provide an opportunity for intruders to access their properties. They also suggest the restrictions were installed to provide access to the rear of these properties if required by the Fire Brigade.

8. As it is not clear if petitioners are asking for the proposed scheme to be amended or for the proposals to be deferred altogether, it is recommended that the Cabinet Member discusses with petitioners their concerns to determine a possible course of action and incorporate this in the forthcoming report outlining all representation received from residents of Austin Road, Little Road and Silverdale Road during statutory consultation.

Financial Implications

There are none associated with the recommendations to this report.

EFFECT ON RESIDENTS, SERVICE USERS & COMMUNITIES

What will be the effect of the recommendation?

To allow the Cabinet Member to fully understand the petitioner's concerns with the proposed parking scheme. The petition can be considered in relation to all other representations received from statutory consultation for a proposed parking scheme.

Consultation Carried Out or Required

Statutory consultation was carried out for a three week period between 25th May – 15th June inviting residents and members of the public to object to the proposals or make comments or representations.

CORPORATE IMPLICATIONS

Legal

There are no special legal implications for the proposal, which amounts to an informal consultation. A meeting with the petitioners is perfectly legitimate as part of a listening exercise, especially where consideration of the policy, factual and engineering issues are still at a formative stage. Fairness and natural justice requires that there must be no predetermination of a decision in advance of any wider non-statutory consultation.

Should there be a decision that further measures are to be considered then the relevant statutory provisions will have to be identified and considered.

In considering any informal consultation responses, decision makers must ensure there is a full consideration of all representations arising including those which do not accord with the officer recommendation. The decision maker must be satisfied that responses from the public are conscientiously taken into account.

Corporate Landlord

The Corporate Landlord has no comments.

BACKGROUND PAPERS

Little Road petition – June 2011

Hayes Parking Management Scheme – Informal consultation results

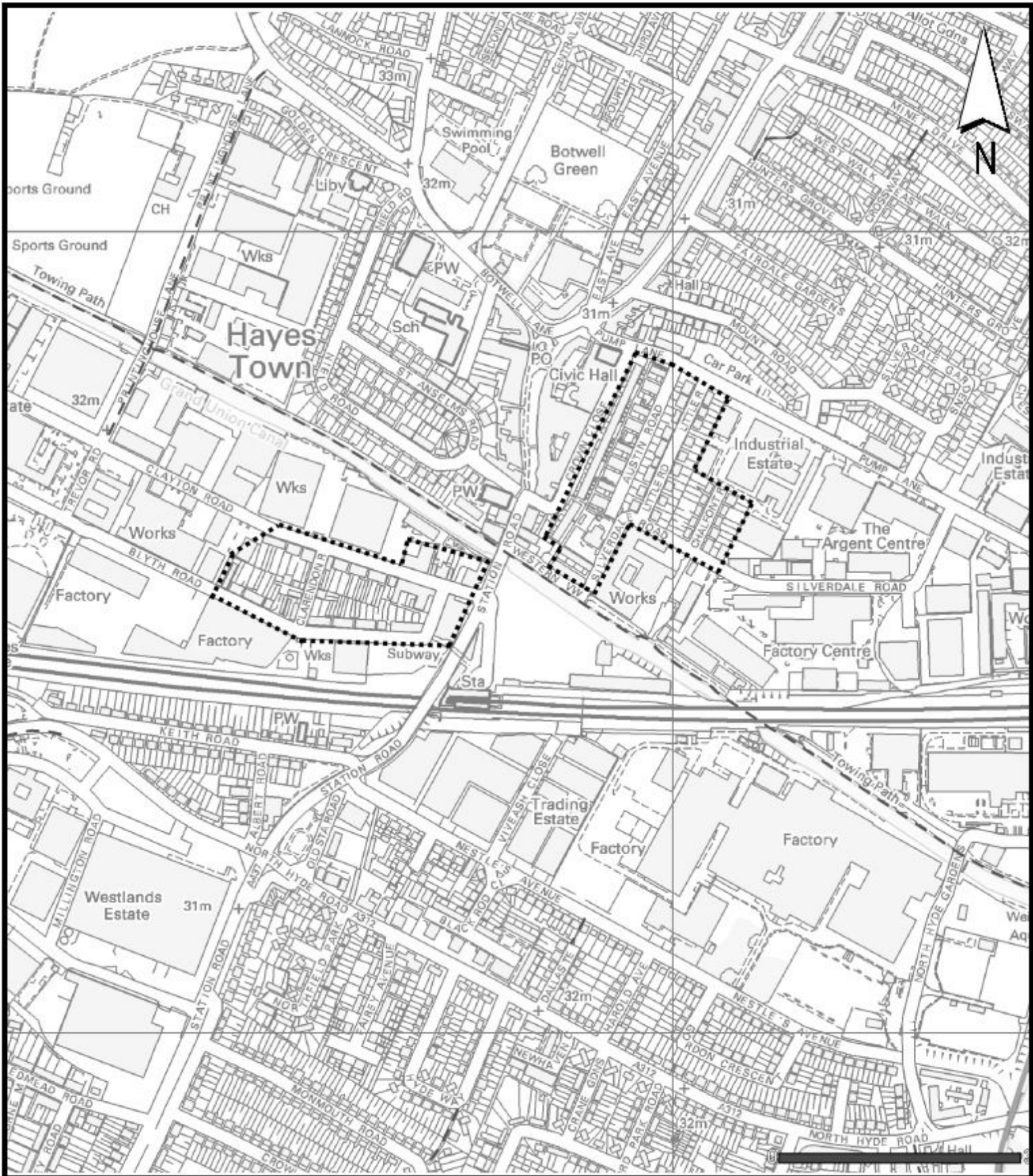

Hayes Parking Management Scheme

Appendix A

Date July 2011

Scale 1:3,000



Boundary of informal consultation area



This page is intentionally left blank

Appendix B

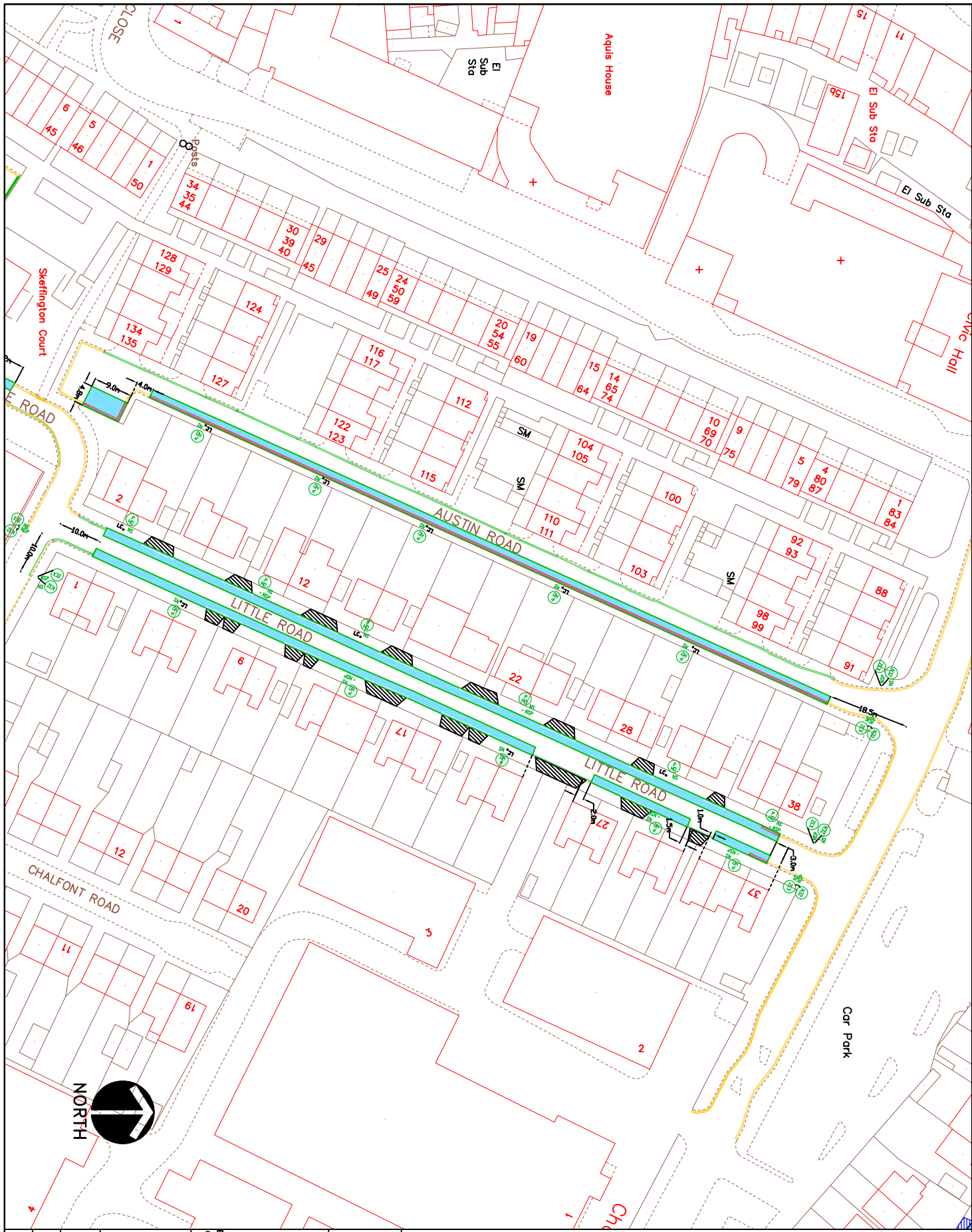

KEY

- EXISTING YELLOW LINE
- NEW DOUBLE YELLOW LINE
- NEW SINGLE YELLOW LINE
- SPLIT & TERMINAL
- CROSSOVER
- PERMIT HOLDER ONLY SIGN
- PERMIT OR TICKET HOLDER
- PAY AT METER - DISPLAY TICKET SIGN
- PAY HERE - DISPLAY TICKET SIGN
- BUSINESS PERMIT HOLDER SIGN
- DISABLED PARKING BAY SIGN
- LOADING ONLY BAY SIGN
- MOTORCYCLES ONLY BAY SIGN
- PERMIT HOLDER AND PAY AND DISPLAY BAY/PLACE ONLY BAY/PLACE
- PAY AND DISPLAY BAY
- PERMIT HOLDER ONLY BAY/PLACE
- LOADING BAY
- MOTORCYCLE BAY
- DISABLED BAY
- PARKING BAYS ARE 2m WIDE UNLESS NOTED

This map is based upon Ordnance Survey data on behalf of the Controller of the Hydrographic Department, Crown copyright. No responsibility is accepted for any error or omission in this map or for any use to which it is put.

London Borough of Hillingdon 100019283 ©2010



HILLINGDON
LONDON

IMPROVEMENT PROJECTS
ENVIRONMENT AND CONSUMER PROTECTION GROUP
CIVIC CENTRE 4W/05, HIGH STREET, UXPB06, UBS 11W
Tel No. 01895 277008/01895 250676

Project
Austin Road & Little Road, Hayes

Description
Proposed Parking Management Scheme

Scale
Drawn (Initials/Date) HT 05/11
Checked (Initials/Date) HT 05/11
Project No. 7.10
Drawing No.
Rev.

This page is intentionally left blank

COLDHARBOUR LANE – PETITION REQUESTING A RESIDENTS PARKING SCHEME

Cabinet Member	Councillor Keith Burrows
Cabinet Portfolio	Cabinet Member for Planning, Transportation and Recycling
Officer Contact	Danielle Watson Planning, Environment, Education and Community Services
Papers with report	Appendix A and B

HEADLINE INFORMATION

Purpose of report	To inform the Cabinet Member that a petition has been received from residents living in Coldharbour Lane, Hayes asking the Council to introduce 'resident only parking' in their part of the road. This request can be considered in relation to the Council's programme for the introduction of managed parking schemes.
Contribution to our plans and strategies	The request can be considered in relation to the Council's strategy for on-street parking controls.
Financial Cost	There are none associated with the recommendations to this report.
Relevant Policy Overview Committee	Residents' and Environmental Services
Ward(s) affected	Townfield

RECOMMENDATION

That the Cabinet Member;

1. Meets and discusses with petitioners their concerns with parking in Coldharbour Lane, Hayes.
2. Subject to the outcome of the discussions with petitioners, approves the request for a 'resident only parking' scheme for the northern end of Coldharbour Lane, Hayes be added to the Council's Parking Programme so that as resources permit, statutory consultation can be carried out on detailed design indicated on Appendix B.

INFORMATION

Reasons for recommendation

The residents have made a specific request for a resident permit parking scheme

Alternative options considered

None at this stage

Comments of Policy Overview Committee(s)

None at this stage

Supporting Information

1. A petition with 20 signatures has been received from residents living in the section of Coldharbour Lane, Hayes between Nos. 251-269 Coldharbour Lane, Hayes. Of the signatures received 17 were from residents living between Nos. 251-269 Coldharbour Lane, Hayes (which represents every household in this section of the road) and 3 signatures were from residents elsewhere in the borough. The location is indicated on the plan attached as Appendix A to this report.
2. Residents have previously submitted a petition requesting residents' parking which was heard in December 2008. The Cabinet Member will recall his decision that this section of Coldharbour Lane, Hayes be added to the Council's Parking Programme so that statutory consultation could be carried out on a detailed design.
3. Statutory consultation was carried out in February 2010 on a detailed design, which is attached as Appendix B to this report. From this consultation two responses were received during the consultation; one resident indicated support for a scheme whilst the other resident requested that the current parking arrangements remain unchanged. The responses were shared with local Ward Councillors whose considered view at the time was that no further action should be taken due to the low number and split responses. The Cabinet Member will recall deferring a decision on this proposed parking scheme and asking officers to keep the area under review and report back if further support is received from residents.
4. It would appear from the petition that residents in this section of Coldharbour Lane now support the principle of managing the parking close to their homes. It is therefore recommended that the Cabinet Member meets and discusses with petitioners their concerns and subject to the outcome asks officers to add the request to the Council's Parking Programme so that as resources permit, statutory consultation can be carried out on the previous proposals indicated on Appendix B. The results of this consultation will be reported to the Cabinet Member and local Ward Councillors and following consideration of any comments that may be received will decide to either proceed with the scheme as proposed, to proceed with the scheme modified in places, or to withdraw the scheme.

Financial Implications

There are no financial implications associated with the recommendations to this report. However if subsequently the Council were to consider the introduction of a Parking Management Scheme in this section of Coldharbour Lane, Hayes as requested, an allocation would be required from a surplus of the Parking Revenue Account to fund the consultation and subsequent implementation.

EFFECT ON RESIDENTS, SERVICE USERS & COMMUNITIES

What will be the effect of the recommendation?

To allow the Cabinet Member to discuss in detail with petitioners their concerns with parking in Coldharbour Lane, Hayes.

Consultation Carried Out or Required

None at this stage

CORPORATE IMPLICATIONS

Legal

This report seeks authority for a meeting with petitioners followed by a statutory consultation. A meeting with the petitioners is perfectly legitimate as part of a listening exercise, especially where consideration of the policy, factual and engineering issues are still at a formative stage. Fairness and natural justice requires that there must be no predetermination of a decision in advance of any wider non-statutory consultation.

The Council's power to make orders creating residents permit parking arrangements are set out in Part IV, Section 45 of the Road Traffic Regulation Act 1984. The consultation and order making statutory procedures to be followed in this case are set out in The Local Authorities' Traffic Orders (Procedures) (England and Wales) Regulations 1996 (SI 1996/2489).

In considering the statutory consultation responses, decision makers must ensure there is a full consideration of all representations arising including those which do not accord with the officer recommendation. The decision maker must be satisfied that responses from the public are conscientiously taken into account. If a local authority decides to embark upon a non-statutory process of consultation the applicable principles are no different from those which apply to statutory consultation: see *R (Partingdale Lane Residents Association) v Barnet London Borough Council* [2003] EWHC 947 (Admin), [2003] All ER (D) 29.

BACKGROUND PAPERS

Petition received – 17th October 2008
Statutory Consultation Report – March 2010
Petition received – 11th August 2011

This page is intentionally left blank

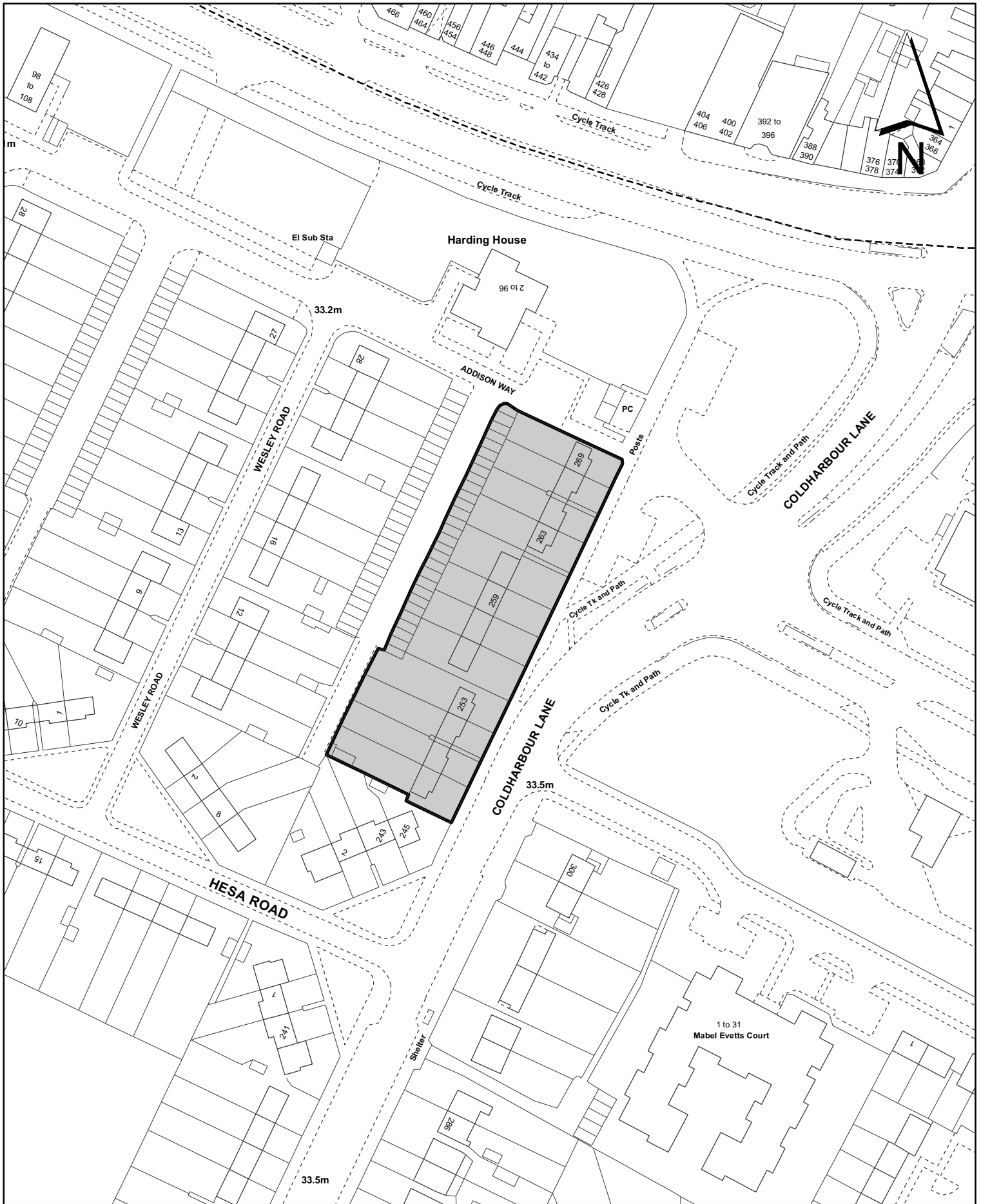

Coldharbour Lane, Hayes Parking Management Scheme

Appendix A

Scale 1:1,250

Date March 2010

 Statutory Consultation Area



This map is based upon Ordnance Survey material with the permission of Ordnance Survey on behalf of the Controller of Her Majesty's Stationery Office © Crown copyright. Unauthorised reproduction infringes Crown copyright and may lead to prosecution or civil proceedings. LB Hillingdon 10019283 2010

This page is intentionally left blank

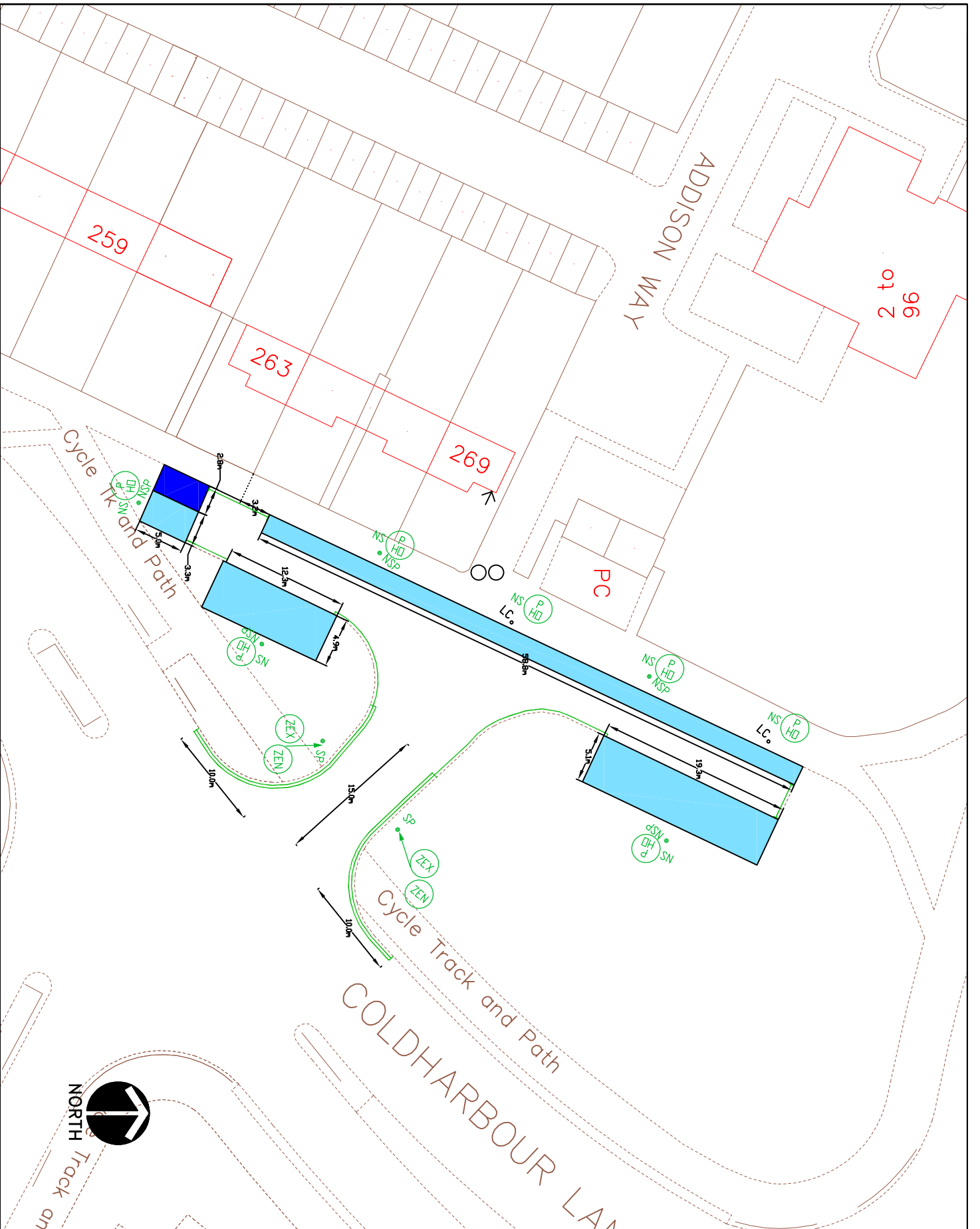

- KEY**
- EXISTING YELLOW LINE
 - NEW DOUBLE YELLOW LINE & TERMINAL
 - NEW SINGLE YELLOW LINE & TERMINAL
 - PERMIT HOLDER ONLY SIGN
 - PERMIT HOLDER ONLY SIGN
 - BAY/PLACE
 - PERMIT HOLDER ONLY SIGN
 - DISABLED BAY
 - PARKING BAYS ARE 2m WIDE UNLESS NOTED

This map is based upon Ordnance Survey data and is the property of the Controller of Her Majesty's Stationery Office. Crown copyright. Reproduction in any form without the written permission of the Controller of Her Majesty's Stationery Office is prohibited. All rights reserved.

London Borough of Hillingdon 100019283 ©2010



IMPROVEMENT PROJECT
ENVIRONMENT AND CONSUMER PROTECTION GROUP
 ONE CENTRE 4W/05, HIGH STREET, UXPAGE, UB8 1UW
 Tel No. 01895 277096/01895 250676

Project
COLDHARBOUR LANE, HAYES

Description
PROPOSED RESIDENTS PERMIT SCHEME

Scale	Drawn	Checked
1/500 DW	28/12/09	DW 28/12/09
Project No.	Drawing No.	Rev.
		A

This page is intentionally left blank

NEW BROADWAY, UXBRIDGE ROAD – PETITION REQUESTING A STOP & SHOP PARKING SCHEME

Cabinet Member	Councillor Keith Burrows
Cabinet Portfolio	Cabinet Member for Planning, Transportation and Recycling
Officer Contact	Kevin Urquhart Planning, Environment, Education and Community Services
Papers with report	Appendix A

HEADLINE INFORMATION

Purpose of report	To inform the Cabinet Member that a petition has been received from a shopkeeper in the New Broadway shopping parade along Uxbridge Road pointing out problems with parking and asking the Council to find a solution. This request is considered in relation to the Council's parking programme for "Stop & Shop" schemes.
Contribution to our plans and strategies	The request can be considered in relation to the Council's strategy for on-street parking controls.
Financial Cost	There are none associated to the recommendation of this report.
Relevant Policy Overview Committee	Residents' and Environmental Services
Ward(s) affected	Hillingdon East

RECOMMENDATION

That the Cabinet Member:

- 1. Meets with petitioners and discusses their concerns about the parking situation in New Broadway Parade, Uxbridge Road.**
- 2. Subject to (1), asks officers to add the request to the future Parking Scheme Programme and when resources permit to carry out informal consultation with business occupiers and residents of New Broadway to establish if there is sufficient support for the consideration of a "Stop & Shop" scheme.**

INFORMATION

Reasons for recommendation

To provide the Cabinet Member with additional information to determine if there is potential for the introduction of a controlled parking scheme along New Broadway.

Alternative options considered

These can be discussed with the petitioners.

Comments of Policy Overview Committee(s)

None at this stage.

Supporting Information

1. A petition of 73 valid signatures out of 415 organised by a business occupier of New Broadway Parade, has been submitted to the council under the following heading:

“We the undersigned request the London Borough of Hillingdon Council allow short term, stop & shop pay parking on the island located between New Broadway and the Uxbridge Road to stimulate trade for the shop keepers.”

2. The petitioners appear to be effectively asking the Council to install a “Stop & Shop” parking scheme. The Council’s policy for the introduction of controlled parking schemes is that they must be supported by the majority of those who respond to the consultation. From the petition submitted it would appear that most of the business occupiers and their customers have signed the petition but there are none from the residents who live above the parade. Should the Cabinet Member wish to give consideration to the introduction of a ‘Stop & Shop’ scheme, it is recommended that the Council undertakes its own informal consultation to determine if there is sufficient support from all of those most directly affected. Subject to the Cabinet Member’s decision the results of such a consultation can be reported back to the Cabinet Member for consideration.

3. New Broadway is situated on the north eastern side of Uxbridge Road between Denziloe Avenue and Lees Road and shown on Appendix A. A service road runs directly along the property frontage and parking currently takes place on the north east side. The junction with Lees Road is controlled by traffic signals and motorists can only turn left onto the Uxbridge Road from New Broadway. It is a predominately commercial frontage but at its northwestern end, there are some residential properties and also residents living above the shops.

4. The Cabinet Member will be aware that the shopkeepers have previously petitioned for a ‘Stop & Shop’ parking scheme. However, following informal consultation with the shopkeepers and residents living above the shops a scheme was not progressed any further as the majority of responses to the consultation indicated they were happy with the existing parking arrangements. It is the Council’s practice not to introduce controlled parking schemes unless they receive full support from the majority who respond to these consultations. Therefore it was decided that no further action should be taken at that stage to install a scheme.

5. It would appear from this new petition there is increasing concern with uncontrolled parking in the service road in front of New Broadway Parade and that business occupiers would like a 'Stop & Shop' scheme similar to those implemented in other shopping parades.

6. In a covering letter attached to the petition it is suggested that the pay & display parking bays should be installed entirely on the pavement opposite the shops on the centre island as petitioners feel that this area is rarely used by pedestrians. Initial investigations have noted a number of utility company inspection covers and other street furniture on this island that may affect what parking could take place here. However, it is suggested that subject to the outcome of the recommended informal consultation the Cabinet Member may decide to approve statutory consultation on a detailed design where these issues would be investigated in greater detail.

Financial Implications

There are no financial implications in relation to the recommendation of this report.

EFFECT ON RESIDENTS, SERVICE USERS & COMMUNITIES

What will be the effect of the recommendation?

It will provide the Cabinet Member with further information on the likely support for a controlled parking scheme in New Broadway before deciding if a proposal should be added to the Council's parking programme.

Consultation Carried Out or Required

One of the recommendations is that informal consultation is carried out with residents and business occupiers of New Broadway.

CORPORATE IMPLICATIONS

Head of Corporate Property & Construction

None at this stage.

Legal

A meeting with the petitioners is perfectly legitimate as part of a listening exercise, especially where consideration of the policy, factual and engineering issues are still at a formative stage which is clearly the case in this instance. Fairness and natural justice requires that there must be no predetermination of a decision in advance of any wider non-statutory consultation.

Should there be a decision that formal parking and traffic controls are to be considered then the relevant statutory provisions will have to be followed.

BACKGROUND PAPERS

Petition received by Democratic Services – 19th September 2011

PART 1 – MEMBERS, PUBLIC AND PRESS
Cabinet Member meeting with Petitioners – 14 December 2011

Decisions sheet published by Democratic Services on 15th September 2009

Cabinet Member report - New Broadway shopping parade, Uxbridge Road –
Results of consultation for a proposed parking scheme - 26th August 2009

Minutes from petition hearing with the Cabinet Member, March 2009



New Broadway, Hillingdon

Appendix A

Date November 2011

Scale 1:4,000



Extent of service road fronting New Broadway

This page is intentionally left blank